

# INVERTED THRU BOARD CARD EDGE AND INVERTED POKE-IN PLATFORM CONNECTORS

The Inverted Card Edge and Poke-In Platform Connectors provide 3.0mm creep and clearance from all other conductive components on FR4 and metal clad printed circuit boards (PCB). The 2 position connectors share the same PCB footprint while offering flexibility in providing either a direct power driver board one piece mating solution or a poke-in wire connection to the underside of the LED array boards.

## ELECTRICAL

- Operating Voltage: 400 VAC / VDC
- Operating Current:
  - 3 A, Inverted Card Edge and 18-22 AWG Poke-In
  - 2 A, 24-26 AWG Poke-In
- Operating Temperature: -20 to 130°C
- 3mm creep and clearance from contacts to metal clad printed circuit board (MCPCB) substrate for non-isolated line voltage power supplies (dielectric withstand voltage)

## MECHANICAL

### Inverted Card Edge Termination:

- Offered in two versions to accept 1.0mm or 1.6mm driver boards
- Polarity keying retention feature options provide additional retention force
- Upto 5 mating cycles

### Inverted Poke-In Termination:

- Offered in two versions for poke-in termination of 18 AWG stranded and 18-22 AWG solid and pre-bonded wire or 24-26 AWG solid wire
- Added 1mm depth dimension to accommodate the wire insulation guide barrels
- Single insertion mating

## MATERIALS

- Housing and Cover: 94 V-0 rated high temperature resistant thermoplastic
- Contacts: Tin over nickel plated copper alloy

## BENEFITS

- The inverted thru board ITB connectors are surface mounted at the same time as other devices on the PCB significantly reducing secondary processes
- Low profile, space-saving connector designed with and without a cover
- The 1.55mm without cover or 1.90mm with cover height above the PCB helps minimize LED light obstruction
- Surface mount hold downs provide stability during driver board mating, un-mating and poke-in mating
- Flat top surface helps to allow for vacuum pick up
- Tape and reel packaging for high speed SMT processing
- Designed with round corners to help minimize shadowing
- Both the Inverted Poke-in and Inverted Card Edge Connectors are available with an optional cap that provides for a touch safe design once soldered to the printed circuit board

## APPLICATIONS

- Retrofit LED bulbs
- Track lighting
- Spot lights
- Down lights

## STANDARDS AND SPECIFICATIONS

- UL 1977
- CSA Std. C22.2 No. 182.3
- Product Specification: [108-32041](#)
- Application Specification: [108-32054](#)

# INVERTED THRU BOARD CARD EDGE & INVERTED POKE-IN PLATFORM CONNECTORS

## PRODUCT OFFERING

Part Number	Inverted Through Board Connector Style	Board Thickness	Wire Gauge
<a href="#">2213188-1</a>	Card Edge	1.0mm	
<a href="#">2213188-2</a>	Card Edge	1.6mm	
<a href="#">2213188-3</a>	Card Edge with Pre-installed Cover	1.0mm	
<a href="#">2213188-4</a>	Card Edge with Pre-installed Cover	1.6mm	
<a href="#">2213189-1</a>	Poke-In		18-22 AWG
<a href="#">2213189-2</a>	Poke-In		24-26 AWG
<a href="#">2213189-3</a>	Poke-In with Pre-installed Cover		18-22 AWG
<a href="#">2213189-4</a>	Poke-In with Pre-installed Cover		24-26 AWG



## PRODUCT DIMENSIONS

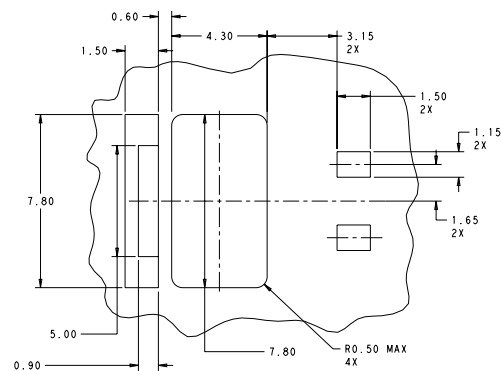
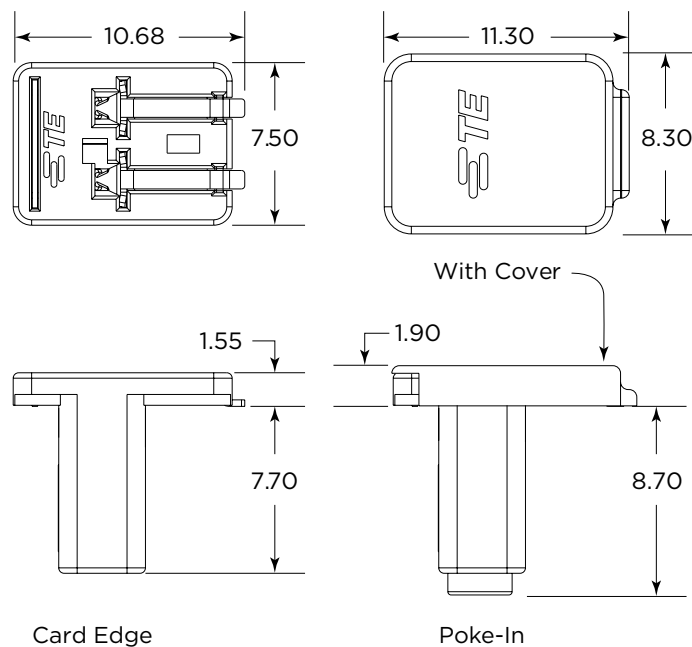

Board Layout

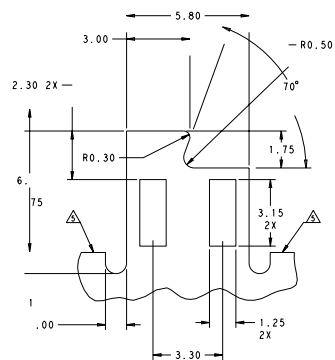

Mating PCB detail

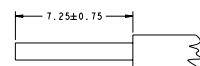

Wire preparation detail

### View Products

### Contact Our Product Team

We make it easy to connect with our experts and are ready to provide the support you need.

Visit [te.com/support](https://te.com/support) to chat with a Product Information Specialist.

### [te.com/inverted-thru-board-connectors](https://te.com/inverted-thru-board-connectors)

TE Connectivity, TE, TE connectivity (logo) and EVERY CONNECTION COUNTS are trademarks owned or licensed by the TE Connectivity plc family of companies. All other logos, products and/or company names referred to herein might be trademarks of their respective owners.

While TE has made every reasonable effort to ensure the accuracy of the information in this document, TE does not guarantee that it is error-free, nor does TE make any other representation, warranty or guarantee that the information is accurate, correct, reliable or current. TE reserves the right to make any changes to the information contained herein without prior notice. TE Connectivity's obligations shall only be as set forth in TE Connectivity's Standard Terms and Conditions of Sale for this product and in no case will TE Connectivity be liable for any incidental, indirect, or consequential damages arising out of the sale, resale, use, or misapplication of the product. TE expressly disclaims any implied warranties with respect to the information contained herein, including, but not limited to, implied warranties of merchantability or fitness for a particular purpose. Dimensions, specifications and/or information contained herein are for reference purposes only and are subject to change without notice. Consult TE for the latest dimensions, specifications and/or information. Users of TE Connectivity products must make their own assessment as to whether the respective product is suitable for the respective desired application.

© 2025 TE Connectivity. All Rights Reserved.

06-25